

# Vortex Pump

15780-0000 SPARES BULLETIN



## Revised spares part numbers are being introduced following design improvements to the Jabsco Vortex pumps.

- Revised spares part numbers are being introduced following design improvements to the Jabsco Vortex pumps.
- The improvements affect key major components that benefit internal pump pressures.
- To ensure pump performance, all parts of the revised kits must be used, no mix and matching
- Existing spares part numbers have been superseded by new part numbers. The new spare part kits contents have changed.
- Pumps with Serial numbers of 011301-01 onwards have the modified components incorporated already.

### WHAT'S CHANGED IN THE KITS

- 15294-1010 Wear ring kit is now 15294-1020. The new kit contains 5 off set screws in addition to the modified wear ring
- 15298-1010 Bronze impeller kit is now 15294-1020. The new kit contains the modified wear ring and modified bronze impeller
- 99202-0000 Major Service Kit is now 99202-1000. The new kit has had the Impeller & Wear ring removed
- 90202-0000 Minor service kit has been deleted from the range and is replaced by 99202-1000

### WHEN TO USE THE KITS

- Use 15294-1020 if pump refurbishment is to utilise the existing impeller. For pumps prior to Serial 011301-01 the set screws block threaded holes in the bronze impeller
- Use 15298-1020 if the refurbished pump is having its wear ring and bronze impeller replaced
- Use Kit 15298-1020 and kit 99202-1000 where full pump service would have been made using the now superseded 99202-0000

### HOW TO USE UP EXISTING KITS

- 90202-0000 can be used without restriction.
- 99202-0000 can be used on all pumps prior to 011301-01
- 15294-1010 and 15298-1010 should be used up in pairs on pumps prior to serial number 011301-01. They must not be used on pumps after this serial number and not used on pumps that have previously been upgraded using the new kits 15294-1020 and/or 15298-1020

All kits come with instructions and assembly guides. Kits should only be used by competent and qualified personnel.

Item	Description	Jabsco kit #	99202-1000	15294-1020	15298-1020
1	Flapper Assembly	Qty	1		
2	Shaft		1		
3	Plate		2		
4	Cam Ring		1		
5	Flexible Impeller		1		
6	Nut		1		
7	Dowel Pin		1		
8	Square Key (Short)		1		
9	Square Key (Long)		1		
10	Split lock washer		1		
11	Flat Washer		6		
12	Retaining ring (small)		1		
13	Retaining ring (large)		1		
14	O-Ring (medium)		3		
15	O-Ring (x-large)		2		
16	O-Ring (large)		1		
17	O-Ring (small)		1		
18	Cotter pin		1		
19	Pipe plug		1		
20	Lip seal (large)		1		
21	Lip seal (small)		1		
22	Screw		6		
23	Mechanical seal		1		
24	Bearing (ball)		2		
25	Set screw M12			5	
26	Wear ring			1	1
27	Bronze Impeller				1

# Vortex Pump

15780-0000 SPARES BULLETIN

## Jabsco Vortex Pump Serial Numbering Logic

	Month	Year	Work Order Qty	Sequential Pump No
Example	01	11	50	35

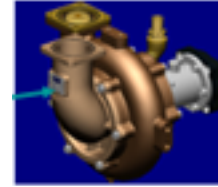

Traceability: The example pump was in January of 2011, there were 50 pumps made in that month of which this is the 35<sup>th</sup> pump in the batch

